

BEFORE THE NEW MEXICO PUBLIC REGULATION COMMISSION

IN THE MATTER OF THE APPLICATION)
OF PACIFIC WIND DEVELOPMENT LLC)
FOR APPROVAL OF THE LOCATION)
OF THE LA JOYA WIND PROJECT AND)
345 KV GEN-TIE LINE IN)
TORRANCE COUNTY, NEW MEXICO)
PURSUANT TO NMSA § 62-9-3; AND)
RIGHT OF WAY WIDTH DETERMINATION)
PURSUANT TO NMSA § 62-9-3.2)

Case No. 18-~~00353~~-UT

FILED IN OFFICE OF

NOV 19 2018

NM PUBLIC REGULATION COMM
RECORDS MANAGEMENT BUREAU

DIRECT TESTIMONY OF

DR. BARBARA K. MONTGOMERY

ON BEHALF OF PACIFIC WIND DEVELOPMENT LLC

November 19, 2018

CASE NO. 18-_____-UT
DIRECT TESTIMONY OF DR. BARBARA K. MONTGOMERY

1 I. WITNESS INTRODUCTION AND QUALIFICATIONS

2 Q. PLEASE STATE YOUR NAME AND BUSINESS ADDRESS.

3 A. My name is Barbara K. Montgomery. My business address is 1575 E. River Road, Suite
4 201, Tucson, Arizona, 85718.

5 Q. BY WHOM ARE YOU EMPLOYED AND IN WHAT CAPACITY?

6 A. I am employed by Tierra Right of Way as a Principal Investigator for cultural resource
7 projects.

8 Q. PLEASE DESCRIBE YOUR EDUCATIONAL BACKGROUND AND
9 EXPERIENCE.

10 A. I received a B.A., M.A. and Ph.D. in Anthropology, all from the University of Arizona. I
11 have 30 years of experience as an anthropologist and have performed hundreds of cultural
12 resource surveys across Arizona and New Mexico. I am an expert in National Historic
13 Preservation Act Section 106 compliance and eligibility evaluation, and I coordinate
14 regularly with regulatory agencies concerned with the proper stewardship of public lands
15 and cultural resources, including the State Historic Preservation Office, the New Mexico
16 State Land Office, and other State and Federal agencies. A copy of my resume is included
17 in Exhibit BKM-1.

18 Q. ON WHOSE BEHALF ARE YOU APPEARING IN THIS PROCEEDING?

19 A. I am testifying on behalf of the applicant, Pacific Wind Development LLC ("Pacific
20 Wind").

21 Q. WHAT IS THE PURPOSE OF YOUR TESTIMONY?

22 A. My testimony supports Pacific Wind's application to the New Mexico Public Regulation
23 Commission ("Commission") for location approval of the La Joya Project. The La Joya

CASE NO. 18-_____ -UT
DIRECT TESTIMONY OF DR. BARBARA K. MONTGOMERY

1 Project includes up to 500 Megawatts ("MW") of wind generation (the "Wind Project"), a
2 345 kV generation tie transmission line ("Gen-Tie Line"), the La Joya Substation, and the
3 Torrance Switching Station. The Gen-Tie Line, La Joya Substation, and Torrance
4 Switching Station are collectively referred to as the "Gen-Tie Facilities." The Gen-Tie
5 Facilities and Wind Project are described in the Direct Testimony of Mark Stacy.

6 My testimony addresses the cultural resources in the approximately 18-mile long,
7 1,000-foot wide corridor, within which the 150-foot wide right-of-way ("ROW") for the
8 Gen-Tie Line will be located and within or adjacent to which the La Joya Substation and
9 Torrance Switching Station will be located (the "Gen-Tie Corridor"), and a surrounding
10 0.5 km buffer area in order to address the statutory standard that the Commission shall
11 approve the location of the transmission line unless the location will unduly impair
12 important environmental values. I also address cultural resources in the area within which
13 wind turbines will be sited (the "Wind Project Area") and a surrounding 0.5 km buffer area.

14 **Q. HAVE YOU TESTIFIED BEFORE ANY REGULATORY AUTHORITIES?**

15 **A.** I have not provided testimony before any regulatory authorities.

16 **Q. WHAT EXHIBITS DO YOU SPONSOR AS PART OF YOUR TESTIMONY?**

17 **A.** I sponsor Exhibit BKM-1, which is my resume; and Exhibit BKM-2, which is the report
18 regarding the Class I cultural resource records search for the La Joya Project.

19 **Q. WERE EXHIBITS BKM-1 AND BKM-2 PREPARED BY YOU OR UNDER YOUR**
20 **SUPERVISION?**

21 **A.** Yes.

22 **Q. ARE EXHIBITS BKM-1 AND BKM-2 TRUE AND CORRECT COPIES OF THE**
23 **DOCUMENTS YOU DESCRIBE IN YOUR TESTIMONY?**

CASE NO. 18-_____-UT
DIRECT TESTIMONY OF DR. BARBARA K. MONTGOMERY

1 A. Yes.

II. **BACKGROUND ON CULTURAL RESOURCES**

2 Q. **WHAT ARE CULTURAL RESOURCES?**

3 A The term "cultural properties" or "cultural resources" generally refers to structures, places,
4 sites or objects having historic, archaeological, scientific, architectural or other cultural
5 significance.

6 Q. **ARE THERE STATE AND FEDERAL LAWS IN PLACE REGARDING**
7 **CULTURAL RESOURCE PROTECTION?**

8 A. Yes, there are state and federal laws in place regarding cultural resources, although the
9 level of protection depends upon the significance of the cultural resource itself, the land
10 tenure status, and/or whether federal or state permits are required.

11 Q. **PLEASE EXPLAIN THE STATE LAWS REGARDING CULTURAL**
12 **RESOURCES.**

13 A. The New Mexico Cultural Properties Act, NMSA 1978 § 18-6-1 *et seq.* ("NMCPA")
14 provides for the preservation, protection, and enhancements of, among other things,
15 archeological sites and historic buildings on state lands. The NMCPA and its implementing
16 regulations require state agencies and political subdivisions of the state to notify the New
17 Mexico State Historic Preservation Office ("SHPO") of their activities that may affect a
18 significant cultural property listed on the State Register of Cultural Properties ("State
19 Register"). The NMCPA also affords protection to marked and unmarked human burials
20 on state and private lands. As long as marked burials are avoided, construction may
21 proceed without consultation with the SHPO. If an unmarked burial were to be encountered
22 during construction, construction activities in the vicinity of the burial must cease while

CASE NO. 18-_____-UT
DIRECT TESTIMONY OF DR. BARBARA K. MONTGOMERY

1 consultation with the SHPO occurs. Depending on the location, the Project may be able to
2 make a field change to the proposed layout of facilities to avoid disturbing the burial site.

3 **Q. PLEASE EXPLAIN THE FEDERAL LAWS REGARDING CULTURAL**
4 **RESOURCES.**

5 A. The National Historic Preservation Act, 54 U.S.C. 300101 *et seq.* ("NHPA"), requires
6 federal agencies to take into account the effects of certain activities and programs on
7 significant cultural resources listed on or eligible for listing on the National Register of
8 Historic Places ("National Register"). When a federal agency funds, licenses, or permits
9 an activity that may affect cultural resources listed on or eligible for listing on the National
10 Register, the agency must consult with the SHPO in cooperation with the Advisory Council
11 on Historic Preservation in Washington, D.C. to comply with Section 106 of the NHPA.

12 **III. APPLICABILITY TO THE LA JOYA PROJECT.**
13

14 **Q. WILL THE GEN-TIE FACILITIES OR WIND PROJECT BE LOCATED ON**
15 **STATE OR FEDERAL LANDS?**

16 A. It is my understanding that the Project's generating facilities will be located on about
17 25,000 acres of private land and 26,000 acres of state trust land, and the ROW for the Gen-
18 Tie Line will be located on about 300 acres of private land and about 27 acres of state trust
19 land. The La Joya Substation and the Torrance Switching Station will each be located on
20 about 10 acres of private land. Pacific Wind has obtained a lease with the State Land Office
21 for use of the state trust lands. I understand that no Project facilities will be located on
22 federal lands.

23 **Q. DO THE GEN-TIE FACILITIES OR WIND PROJECT REQUIRE REVIEW**
24 **UNDER THE NMCPA?**

CASE NO. 18-_____-UT
DIRECT TESTIMONY OF DR. BARBARA K. MONTGOMERY

1 A. Any portion of the project that falls on State trust lands is required, under the NMCPA, to
2 be reviewed for cultural resources.

3 **Q. DO THE GEN-TIE FACILITIES OR WIND PROJECT REQUIRE REVIEW**
4 **UNDER THE NHPA?**

5 A. No. It is my understanding that the Project does not need any federal permits that require
6 NHPA review. There is no federal land, funding, or permitting involved that would trigger
7 review under the NHPA.

8 **Q. DO THE GEN-TIE FACILITIES OR THE WIND PROJECT REQUIRE**
9 **CONSIDERATION OF POTENTIAL IMPACTS TO CULTURAL RESOURCES**
10 **AS PART OF THE COMMISSION'S LOCATION APPROVAL?**

11 A. I understand that New Mexico Location Statute, NMSA 1978, § 61-9-3, requires the
12 Commission to consider whether the transmission line and associated facilities will unduly
13 impair important environmental values, including cultural resources. I understand that the
14 statute does not apply this standard to generation plants (in this case, the wind turbines);
15 however, Pacific Wind intends to take voluntary measures for the Project as a whole to
16 avoid or minimize impacts to cultural resources.

17 **Q. PLEASE EXPLAIN PACIFIC WIND'S VOLUNTARY MEASURES TO IDENTIFY**
18 **AND AVOID IMPACTS TO CULTURAL RESOURCES.**

19 A. Pacific Wind intends to site Project structures and facilities to avoid impacts to known
20 cultural resources that have been recommended or determined eligible for listing on the
21 National Register of Historic Places ("NRHP") or on the State Register, or cultural
22 resources that remain unevaluated as to eligibility. As I explain below, Pacific Wind also

CASE NO. 18-_____-UT
DIRECT TESTIMONY OF DR. BARBARA K. MONTGOMERY

1 proposes to implement an Unanticipated Discoveries Plan to avoid or minimize impacts to
2 human remains and cultural resources that are discovered during construction.

3 **IV. CULTURAL RESOURCES IN THE STUDY AREA.**

4 **Q. PLEASE PROVIDE AN OVERVIEW OF THE PROCESS YOU USED TO**
5 **IDENTIFY CULTURAL RESOURCES AT THE PROJECT SITE.**

6 A. We performed a search of records maintained by the New Mexico Cultural Resource
7 Information System ("NMCRIS") to determine the extent of archeological work performed
8 and whether any sites have been recorded within the Gen-Tie Corridor or the Wind Project
9 Area, including a 0.5 km buffer surrounding each area.

10 **Q. PLEASE DESCRIBE YOUR FINDINGS REGARDING KNOWN CULTURAL**
11 **RESOURCES IN THE STUDY AREA.**

12 A. The search found that 26 previously recorded sites are present within the Gen-Tie
13 Corridor, the Wind Project Area, and the surrounding buffer areas. Twelve of these sites
14 are located within the Gen-Tie Corridor or the Wind Project Area, the remaining fourteen
15 sites are within the buffer areas. The sites range from prehistoric lithic quarries to historic
16 homesteads.

17 **Q. ARE ANY OF THE KNOWN CULTURAL RESOURCE SITES LOCATED**
18 **WITHIN THE GEN-TIE CORRIDOR?**

19 A. Three sites are located with the Gen-Tie Corridor, and another ten sites are located within
20 the surrounding 0.5 km buffer area. None of the three sites within the Gen-Tie Corridor
21 have been determined or recommended to be eligible for the National Register. One site
22 within the buffer area, a prehistoric artifact scatter, has been determined eligible for the

CASE NO. 18-_____-UT
DIRECT TESTIMONY OF DR. BARBARA K. MONTGOMERY

1 National Register by the SHPO; one other site within the buffer area, a multicomponent
2 artifact scatter, has been recommended to be eligible by the recorder.

3 **Q. ARE ANY OF THE KNOWN CULTURAL RESOURCE SITES LOCATED**
4 **WITHIN THE WIND PROJECT AREA?**

5 A. Eight sites are located with the Wind Project Area, and another five sites are located within
6 the surrounding 0.5 km buffer area. None of these sites have been determined eligible for
7 the National Register. Three sites located within the buffer area – two historic homestead
8 and a cemetery – have been recommended eligible by the recorders. Five of the sites within
9 the Wind Project Area have not been evaluated for eligibility.

10 **Q. DID YOUR REVIEW FIND ANY CEMETERIES OR HUMAN REMAINS IN THE**
11 **GEN-TIE CORRIDOR OR WIND PROJECT AREA?**

12 A. No cemeteries or human remains have been found in the Gen-Tie Corridor or the Wind
13 Project Area, although a historic cemetery, the Negra Cemetery (LA 174967), is located
14 on private land in the 0.5 km buffer to the northeast of the Wind Project Area (see Figure
15 A.12 in Exhibit BKM-2).

16 **Q. WILL PACIFIC WIND PERFORM ANY FURTHER STUDIES TO IDENTIFY**
17 **CULTURAL RESOURCES?**

18 A. Yes. A Class III archeological survey will be performed on state trust lands that have not
19 been surveyed previously during the past 10 years prior to any ground-disturbing activities.
20 All sites on state trust lands within the Gen-Tie ROW and the Wind Project Area will be
21 evaluated for National Register eligibility. Pacific Wind will also contract with Tierra to
22 conduct a Class II survey to determine National Register eligibility of cultural resources
23 on private lands in the Gen-Tie ROW and the Wind Project Area.

CASE NO. 18-_____-UT
DIRECT TESTIMONY OF DR. BARBARA K. MONTGOMERY

1 **Q. HOW WILL THE PROJECT DEAL WITH UNANTICIPATED DISCOVERIES**
2 **DURING CONSTRUCTION?**

3 **A. I understand that Pacific Wind proposes the Unanticipated Discoveries Plan included in**
4 **Exhibit MS-20, so that in the unlikely event that human remains, cultural resources, or**
5 **paleontological resources are discovered during ground-disturbing activities, proper**
6 **response is ensured and impacts to the remains or resources are avoided or minimized.**

7 **V. CONCLUSION**

8 **Q. PLEASE SUMMARIZE YOUR OVERALL FINDINGS.**

9 **A. Our records search identified three known sites within the Gen-Tie Corridor, and eight**
10 **sites within the Wind Project Area. None of these sites have been determined or**
11 **recommended to be eligible for the National Register of Historic Places. My understanding**
12 **is that the La Joya Project will avoid all sites recommended or determined eligible for the**
13 **National Register or State Register and all unevaluated sites on state land. Pacific Wind**
14 **also intends to avoid sites on private lands, if practicable. In the unlikely event that an**
15 **unanticipated discovery of human remains or cultural resources is made, the Project will**
16 **follow the proposed Unanticipated Discoveries Plan to ensure proper response and**
17 **avoidance or minimization of impacts.**

18 **Q. IN YOUR OPINION, WILL THESE MEASURES ALLOW THE PROJECT TO**
19 **COMPLY WITH APPLICABLE CULTURAL RESOURCE LAWS AND**
20 **REGULATIONS?**

21 **A. Yes.**

CASE NO. 18-_____ -UT
DIRECT TESTIMONY OF DR. BARBARA K. MONTGOMERY

1 **Q. IN YOUR OPINION, WILL THE GEN-TIE FACILITIES UNDULY IMPAIR**
2 **IMPORTANT ENVIRONMENTAL VALUES REGARDING CULTURAL**
3 **RESOURCES?**

4 **A. No. To the contrary, the Gen-Tie Facilities and the Wind Project will avoid or minimize**
5 **impacts to important environmental values regarding cultural resources.**

6 **Q. DOES THIS CONCLUDE YOUR TESTIMONY AT THIS TIME?**

7 **A. Yes, it does.**

8

9



BARBARA K. MONTGOMERY, PH.D.
Senior Principal Investigator/Project Manager

QUALIFICATIONS

Dr. Barbara Montgomery has served as Principal Investigator for most of Tierra's cultural resources projects over the past 16 years, including hundreds of Class III surveys across Arizona and New Mexico. She is an expert in National Historic Preservation Act Section 106 compliance and eligibility evaluation and coordinates on a regular basis with regulatory agencies concerned with the proper stewardship of public lands and cultural resources, including State Historic Preservation Offices, Arizona State Land Department (ASLD), New Mexico State Land Department, the Bureau of Land Management (BLM), and the U.S. Forest Service (USFS).

SELECTED PROJECTS

Senior Principal Investigator, Class III Survey for the El Cabo Additional Transmission Line and Infrastructure Project, Torrance County, New Mexico, 2013-2017

Client: Iberdrola Renewables—Supervised a Class III archaeological survey on 17,090 acres in central New Mexico; responsible for coordinating the Class I research, supervising field work and report writing, and agency submittal.

Senior Principal Investigator, Organ Mountains-Desert Peaks Surveys, Doña Ana County, New Mexico, 2016

Client: BLM, Las Cruces District Office—Supervised Class III archaeological survey of 5 dispersed parcels totaling 1,496 acres. Responsible for coordinating the fieldwork, supervising the report writing, and agency submittal.

Senior Principal Investigator, Skull Valley/Mayer Surveys, Yavapai County, Arizona, 2016

Client: BLM, Hassayampa Field Office—Supervised Class III archaeological surveys of 1,237 acres (BLM) and 400 acres (ASLD). Responsible for coordinating the fieldwork, supervising the report writing, and agency submittal.

Senior Principal Investigator, Yucca Ash Survey, Pima and Santa Cruz Counties, Arizona, 2016

Client: BLM, Tucson Field Office—Supervised Class III archaeological survey on the Las Cienegas National Conservation Area totaling 1,296 acres. Responsible for coordinating the fieldwork, supervising the report writing, and agency submittal.

Senior Principal Investigator, Sopori Ranch Survey, Santa Cruz County, Arizona, 2016

Client: Arizona Land and Water Trust—Supervised Class III survey of 2,570 acres and documentation of 12 sites along Sopori Creek.

PROFESSIONAL EXPERIENCE

Senior Principal Investigator
Tierra Right of Way Services, LLC, Tucson, Arizona

Principal Investigator
Tierra Right of Way Services, LLC, Tucson, Arizona
Responsible for coordinating fieldwork and report writing, ensuring data quality, coordinating with client and agencies.

EDUCATION

Ph.D., Anthropology
University of Arizona, 1992

M.A., Anthropology
University of Arizona, 1989

Professional Memberships
Archaeological Society of America
Society for American Archaeology
Arizona Archaeological and Historical Society (Vice President for Membership 2017-2019)

RELEVANT EXPERIENCE

Principal Investigator
Tierra Right of Way Services, LLC, Tucson, Arizona

2014-present, Project Manager
Tierra Right of Way Services, LLC, Tucson, Arizona

2013-2017, Principal Investigator
Tierra Right of Way Services, LLC, Tucson, Arizona

1994-2001, Research Assistant
Division of Statistical Research, Inc., Tucson, Arizona

1990-1994, Cultural Resources Research, Inc., Tucson, Arizona

Senior Principal Investigator, Holt Gulch Class III Survey, Catron County, New Mexico, 2015

Client: USFS, Gila National Forest—Supervised the survey and write-up of approximately 145 acres in the Glenwood Ranger District, Catron County, New Mexico, and agency submittal.

Senior Principal Investigator, Escudilla East Survey, Catron County, New Mexico, 2015

Client: USFS, Gila National Forest—Supervised the survey and write-up of 882 acres, including the recordation of 30 sites in Luna, and agency submittal.

Senior Principal Investigator/Project Manager, Cibola Roads Survey in Catron, Cibola, Lincoln, McKinley, Sierra, Socorro, and Torrance Counties, New Mexico, 2014–2015

Client: USFS, Cibola National Forest—Supervised and managed the survey of 80 miles of a 200-foot-wide corridor centered on various roads throughout the Mt. Taylor, Magdalena, and Mountainair Districts of the Cibola National Forest. Responsible for agency submittal.

Senior Principal Investigator, Class III Survey for the Pima Road Solar Project, Pinal County, Arizona, 2014

Client: Iberdrola Renewables—Supervised a Class III archaeological survey of 225 acres near Queen Creek; responsible for coordinating the Class I research, supervising fieldwork and report writing, and agency submittal.

Senior Principal Investigator, Class III Survey of Teague Springs Civilian Conservation Corps Camp, Graham County, Arizona, 2014

Client: BLM, Safford Field Office—Supervised and managed the survey of 720 acres of BLM-managed land that involved the Teague Springs Civilian Conservation Corps Camp.

Principal Investigator, Class III Survey for the El Cabo Infrastructure Project, Torrance County, New Mexico, 2012–2013

Client: Iberdrola Renewables—Supervised a Class III archaeological survey on 1,890 acres for in central New Mexico; responsible for coordinating the Class I research, supervising field work and report writing, and agency submittal.

Principal Investigator, Class III Survey for the El Cabo Transmission Line, San Miguel, Santa Fe, and Torrance Counties, New Mexico, 2012

Client: Iberdrola Renewables—Supervised a 3,000-acre Class III archaeological survey for a 15-mile-long transmission line corridor in central New Mexico; responsible for coordinating the Class I research, supervising field work and report writing, and agency submittal.

Principal Investigator, Survey of 3,000 Acres near Holbrook, Navajo County, Arizona, 2011

Client: BLM, Safford Field Office—Supervised a Class III archaeological survey on four parcels of BLM land totaling 3,000 acres. Responsible for coordinating the fieldwork, supervising the report writing, and agency submittal.



October 29, 2018

Mr. Leif Bang
Permit Manager
Avangrid Renewables
6822 S. Lamar St.
Littleton, Colorado 80128
720-357-3190

Re: Class I Records Search for the La Joya Project, Torrance County, New Mexico

Dear Mr. Bang,

At your request, cultural resource records maintained by the New Mexico Cultural Resource Information System (NMCRIS) were examined to determine the extent of archaeological work performed and whether any sites have been recorded within the surrounding 0.5-km (0.31-mile) buffer zone of the La Joya Project (Project). On June 14, 2018, Tierra archaeologist Chance Copperstone performed the records review using the NMCRIS online database. The Project includes approximately 18 miles of generation transmission tie-line (Gen-Tie Line) and associated infrastructure and approximately 50,000 acres for the associated wind energy generation infrastructure (Wind Project Area) (Figures 1 and 2). The Gen-Tie Line will be located in a 150-foot right-of-way within a 1,000-foot-wide corridor (Gen-Tie Corridor). The Project is located on private land and New Mexico State Land Office lands in Torrance County, New Mexico. Section, Township, Range and USGS quadrangle information for the project area can be found on Figure 1 below.

The Class I search found that 11 surveys have been previously conducted within the Gen-Tie Corridor, the Wind Project Area, and the 0.5-km buffer (Table 1; Figures A.1–A.13). The records check indicates that most of the Gen-Tie Corridor has been previously surveyed by Tierra in 2013 (Jones and Howell 2014), although only very small portions of the Wind Project Area have been previously surveyed (see Figures 3 and 4 [oversized]). Table 3 provides a summary of the percentages of the Project area that have been previously surveyed on State land vs. private land.

The search also found that 26 previously recorded sites are present within the Gen-Tie Corridor, the Wind Project Area, and the 0.5-km buffer (Table 2; Figures A.1–A.13). The sites range from prehistoric lithic quarries to historic homesteads. Twelve of the sites are located within the Gen-Tie Corridor or the Wind Project Area, rather than the buffer, and are shown in bold type in Table 2.

Table 4 lists the sites by National Register of Historic Places (NRHP) eligibility and location. Three sites (LA 177814, LA 178806, and LA 178828) are located within the Gen-Tie Corridor and another 10 sites are



within the 500-m buffer of the corridor. Only one site, LA 109487, a prehistoric artifact scatter, has been determined eligible by SHPO. One other site, LA 178826, a multicomponent artifact scatter, was recommended eligible by the recorder. These two eligible sites are located in the buffer and not in the Gen-Tie Corridor.

The sites recorded in the Wind Project Area are also divided between the Project Area itself and the 500-km buffer (see Table 4). Eight sites are within the Wind Project Area and another five sites are in the buffer. None of the sites in the Wind Project Area, or its buffer, have been determined eligible by SHPO. Three sites (LA 144072 [historic homestead], LA 174967 [Negra Cemetery], and LA 178799 [historic homestead]) in the buffer have been recommended eligible by the recorders.

In addition to sites that have been determined or recommended as eligible for listing on the NRHP, there are seven sites that remain unevaluated. Five of these unevaluated sites are located in the Wind Project Area and should be revisited and evaluated as to eligibility during the Class III survey of the Wind Project Area. The other two unevaluated sites are in the buffer and will not be affected by the Project.

Following regulations regarding cultural resources per the New Mexico State Lands Office and the Historic Preservation Division (*Cultural Properties Act of 1969* [§§18-6-1 through 18-6-23, NMSA 1978]), Tierra recommends a Class III archaeological survey on State lands prior to any ground-disturbing activities related to the Project, excluding those portions that have been surveyed within the past decade (see Appendix A and Figures 3 and 4). All sites on State lands within the Project area will be evaluated for NRHP eligibility. Tierra recommends that eligible (or unevaluated) sites on State lands be avoided.

If you have any questions, please feel free to contact me or Barbara Montgomery, the Project Manager, at (520) 319-2106.

Sincerely,

Chance Copperstone
Staff Archaeologist, Environmental Planning and Cultural Resources Division

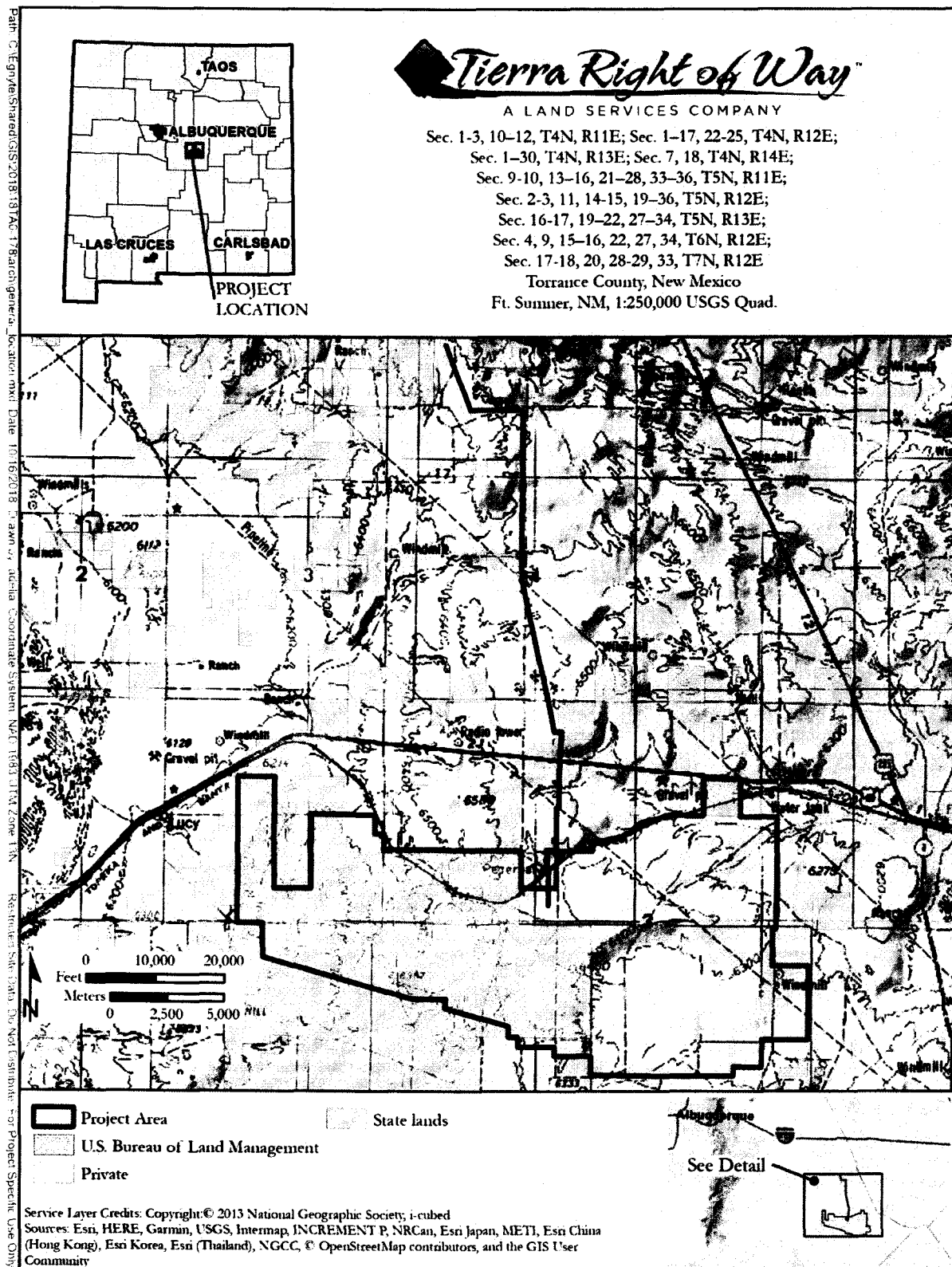

Figure 1. La Joya Project.



Figure 2. Detailed Project area.

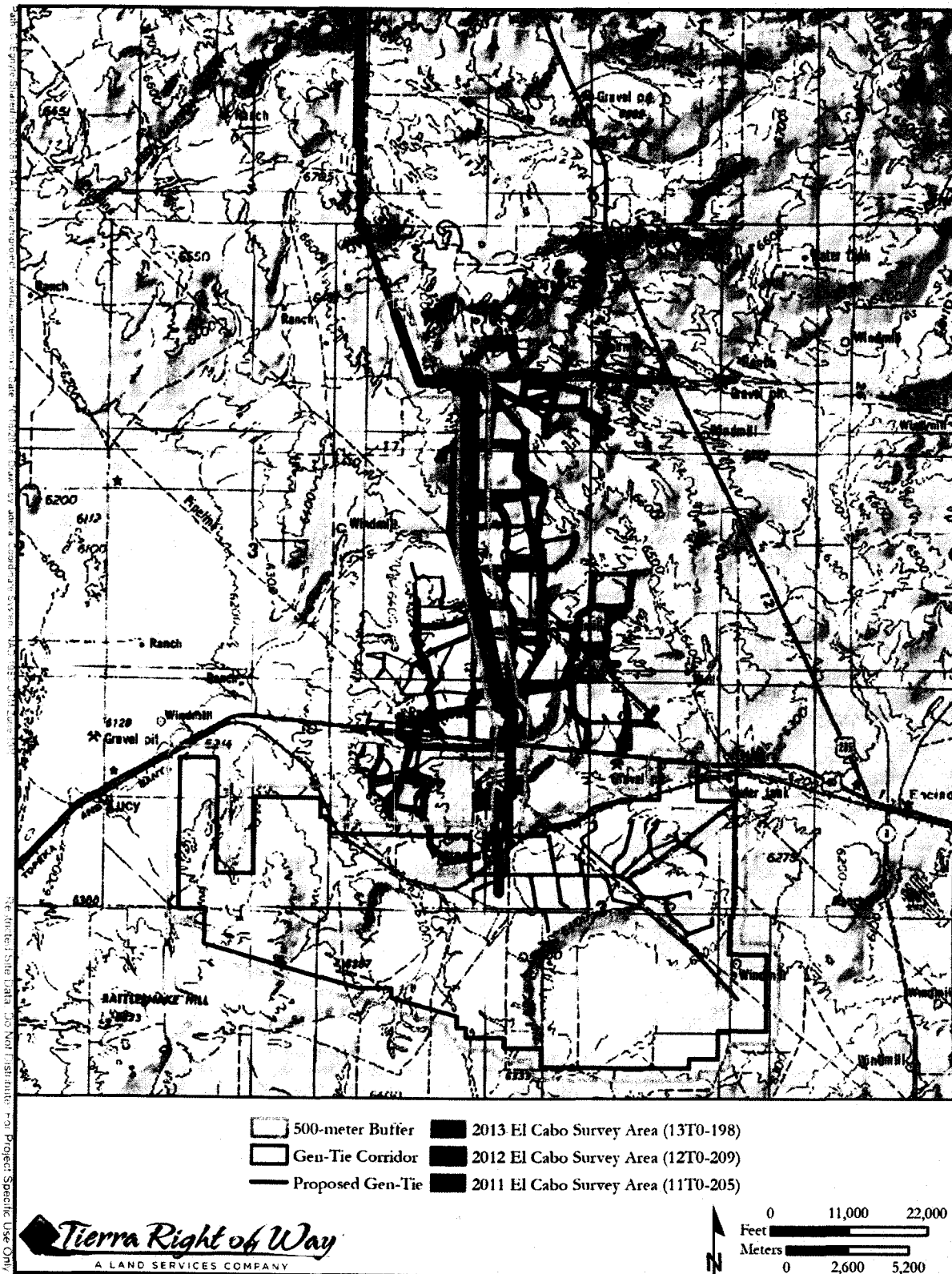

Figure 3. Gen-Tie Corridor, Wind Project Area, and Tierra's previous surveys.

Figure 4. Survey Coverage by Land Jurisdiction. **OVERSIZED MAP** (see pdf file)

Table 1. Previous Surveys within a 0.5-km (0.31-mile) Buffer of the Project Area			
NMCRIS Activity No.	Description	Performing Agency	Report Reference
58	Cultural Resource Inventory, Shell CO2 Mainline	Complete Archaeological Service Associates	Hammack 1981
19154	Reconnaissance Survey of Federally Owned Land in Torrance County	University of New Mexico Office of Contract Archaeology	Kneebone 1987
48969	MAPCO Four Corners survey	University of New Mexico Office of Contract Archaeology	Bradley and Brown 1998
63264	Section 106 Consultation Form (Cultural Resources) 516-Livestock Pipelines (2) for Lucy Ranch	U.S. Natural Resource Conservation Service	Brooks 1998
90218	Block Survey of 2 Acres	U.S. Natural Resource Conservation Service	Gonzales 2004
90493	Linear and Block Survey of 597 Acres	U.S. Natural Resource Conservation Service	Romero-Yepes 2004
97432	Linear Fiber-optics Survey	Tierra Right of Way Services, Ltd.	Doak et al. 2007
126016	El Cabo Wind Power Project 2012	Tierra Right of Way Services, Ltd.	Howell and Jones 2013
128267	Estancia: Encino	U.S. Natural Resource Conservation Service	Dennisson 2013
128771	El Cabo Wind Power Project 2013	Tierra Right of Way Services, Ltd.	Jones and Howell 2014
131552	Proposed Cortez North Loop Pipeline Expansion	SWCA Environmental Consultants, Inc.	Sisneros et al. 2014

Table 2. Previously Recorded Archaeological Sites within a 0.5-km (0.31-mile) Buffer of the Project Area			
LA Number	Site Name/Description	Temporal Placement	NRHP Status
60984	Buck Harvey Ranch	Prehistoric	Not evaluated
60989	Berry Ranch	Unknown	Not evaluated
60992	Tapley Flats (lithic quarry)	Unknown	Not evaluated
85502	artifact scatter	Prehistoric	Unevaluated by SHPO (HPD Log# 41282; no date)
109487	artifact scatter with fire-cracked rock concentrations	Prehistoric	Determined eligible by SHPO (HPD Log# 50462, 5/24/96)
130452	Unknown	Prehistoric	Not evaluated
130453	Unknown	Prehistoric	Not evaluated
138738	Unknown	Historic	Not evaluated
144072	Homestead	Historic	Recommended eligible by recorder
153074	road/trail	Historic	Determined not eligible by SHPO (HPD Log# 77801, 7/7/09)
174962	trash scatter	Historic	Recommended not eligible by recorder
174963	trash scatter	Historic	Recommended not eligible by recorder
174964	Swanson Homestead	Historic	Recommended not eligible by recorder
174967*	Negra Cemetery	Historic	Recommended eligible by recorder (Criterion B)
177805	Archaic lithic scatter	Prehistoric	Recommended not eligible by recorder
177814	Artifact scatter	prehistoric	Recommended not eligible by recorder
178792	Homestead	Historic	Recommended not eligible by recorder
178799	Homestead	Historic	Recommended eligible (C and D) by recorder
178806	trash scatter	Historic	Recommended not eligible by recorder
178813	Historic water well and trash	Historic	Recommended not eligible by recorder
178821	Homestead	Historic	Recommended not eligible by recorder
178824	grinding slicks	unknown	Recommended not eligible by recorder
178825	lithic scatter and trash scatter	Prehistoric and historic	Recommended not eligible by recorder
178826	lithic scatter and trash scatter	Prehistoric and historic	Recommended eligible by recorder

178827	rock foundation	Historic	Recommended not eligible by recorder
178828	rock foundation	Historic	Recommended not eligible by recorder

Bolded sites are within, or partially within, the current Project area.

***Site in 500-km buffer, not in Wind Project Area, but immediately adjacent.**

Table 3. Percentage of Previously Surveyed Portions of Project Area, by State vs. Private Land

	State Land			Private Land			Total Acreage
	% Surveyed	% Not Surveyed	Total Acreage	% Surveyed	% Not Surveyed	Total Acreage	
Gen-Tie Corridor	72	28	109.5	74	26	1,992.5	2,102
Wind Project Area	<1	>99	23,814	2.5	97.5	26,169	49,983
Total	1	99	23,923.5	8	92	28,161.5	52,085

Table 4. Previously Recorded Sites by Location and NRHP Eligibility.

Site Location	Determined Eligible by SHPO	Unevaluated by SHPO	Determined Not Eligible by SHPO	Recommended Eligible by Recorder	Not Evaluated by Recorder	Recommended Not Eligible by Recorder	Total
<i>Gen-Tie Corridor</i>							
within Gen-Tie Corridor							
177814						1	1
178806						1	1
178828						1	1
within buffer							
109487	1						1
153074			1				1
177805						1	1
178792						1	1
178813						1	1
178821						1	1
178824						1	1
178825						1	1
178826				1			1
178827						1	1
<i>Subtotal, Gen-Tie Corridor</i>	<i>1</i>	<i>0</i>	<i>1</i>	<i>1</i>	<i>0</i>	<i>10</i>	<i>13</i>
<i>Wind Project Area</i>							
within Wind Project Area							
60992					1		1
85502		1					1
130452					1		1
130453					1		1
138738					1		1
174962						1	1



References Cited

Bradley, Ronna J., and Kenneth L. Brown

- 1998 *Cultural Resources along the MAPCO Four Corners Pipeline: Huerfano Station, New Mexico, to Hobbs Station, Texas*. Report No. 185-547B, Volume 1. Office of Contract Archaeology, University of New Mexico, Albuquerque.

Brooks, Corinne

- 1998 *Section 106 Consultation Form (Cultural Resources) 516-Livestock Pipelines (2) for Lucy Ranch*. Document on file at U.S. Natural Resource Conservation Service, New Mexico State Office, Albuquerque.

Dennisson, Lisa

- 2013 *Harvey Encino Ranch*. Document on file at U.S. Natural Resource Conservation Service, New Mexico State Office, Albuquerque.

Doak, David P., Renee Erickson, Jenna Hamlin, and Marie-Blanche Roudaut

- 2007 *A Class III (Intensive) Cultural Resource Survey of 23 Segments, Totaling 1310.55 Hectares (3238.43 Acres) of a Fiber Optic Cable Corridor in Colfax, De Baca, Guadalupe, Lincoln, San Miguel, Santa Fe, Socorro, Torrance, and Union Counties, New Mexico*. Archaeological Report Number 2006-57. Tierra Right of Way Services, Ltd, Tucson.

Gonzales, Thomas C.

- 2004 *Ted and Bob McLaughlin/Equip 2004/R12E, Sec. 23, 24*. Document on file at U.S. Natural Resource Conservation Service, New Mexico State Office, Albuquerque.

Hammack, Laurens C.

- 1981 *Cultural Resource Inventory of the Shell CO2 Mainline*. Complete Archaeological Service Associates, Cortez.

Howell, Joseph, and Jeffrey T. Jones

- 2013 *An Intensive Cultural Resource Survey for the Proposed El Cabo Wind Power Project in Torrance County, New Mexico*. Archaeology Report No. 2013-038. Tierra Right of Way Services, Ltd., Tucson.

Jones, Jeffrey T.

- 2012 *An Intensive Cultural Resource Survey for the Proposed El Cabo Wind Power Project in San Miguel, Santa Fe and Torrance Counties, New Mexico*. Archaeological Report No. 2012-041. Tierra Right of Way Services, Ltd., Tucson.

Jones, Jeffrey T., and Joseph Howell

- 2014 *Cultural Resource Survey for the Proposed El Cabo Wind Power Project in Torrance County, New Mexico*. Archaeological Report No. 2015-025. Tierra Right of Way Services, Ltd., Tucson.

Kneebone, Ronald R.

- 1987 *A Reconnaissance Survey of Federally Owned Land in Torrance County, New Mexico*. Report No. 185-340. Office of Contract Archaeology, University of New Mexico, Albuquerque.

Sisneros, Brianne, William Whitehead, and Jim A. Railey

- 2014 *A Cultural Resources Investigation for the Proposed Cortez North Loop Pipeline Expansion, Torrance County, New Mexico*. Report No. 14-468. SWCA, Environmental Consultants, Inc., Albuquerque.

Romero-Yepes, Andrea

- 2004 *Berlier/Brush/Diversions/Encino, NM*. Document on file at U.S. Natural Resource Conservation Service, New Mexico State Office, Albuquerque.

APPENDIX A

Class I Research

CONFIDENTIAL

This appendix contains information on the locations of cultural properties discussed in the report:

Re: Class I Records Search for the La Joya Project, Torrance County, New Mexico

VERIFICATION

STATE OF Arizona)
COUNTY OF Pima) ss.

Barbara K. Montgomery, first being sworn on her oath, states:

I am the witness identified in the foregoing Direct Testimony of Dr. Barbara K. Montgomery. I hereby verify that I have read the foregoing Direct Testimony of Dr. Barbara K. Montgomery and the statements contained therein are true and correct to the best of my knowledge and belief.

Barbara K. Montgomery
Barbara K. Montgomery

Subscribed, sworn to, and acknowledged before me on this 12th day of November, 2018.

Laure McIntosh
Notary Public

My commission expires 11-26-22

