

## Mohawk Solar

Towns of Canajoharie and Minden, Montgomery County, New York

[Article 10 Application](#)

### Figure 3-2: Interconnection Location

Sheet 1 of 2: Map

**Notes:** 1. Basemap: ESRI ArcGIS Online "World Topographic Map" map service. 2. This map was generated in ArcMap by Environmental Design and Research on May 17, 2019. 3. This is a color graphic. Reproduction in grayscale may misrepresent the data.

### Civil Boundaries

- City/Village Boundary
- Town Boundary
- County Boundary



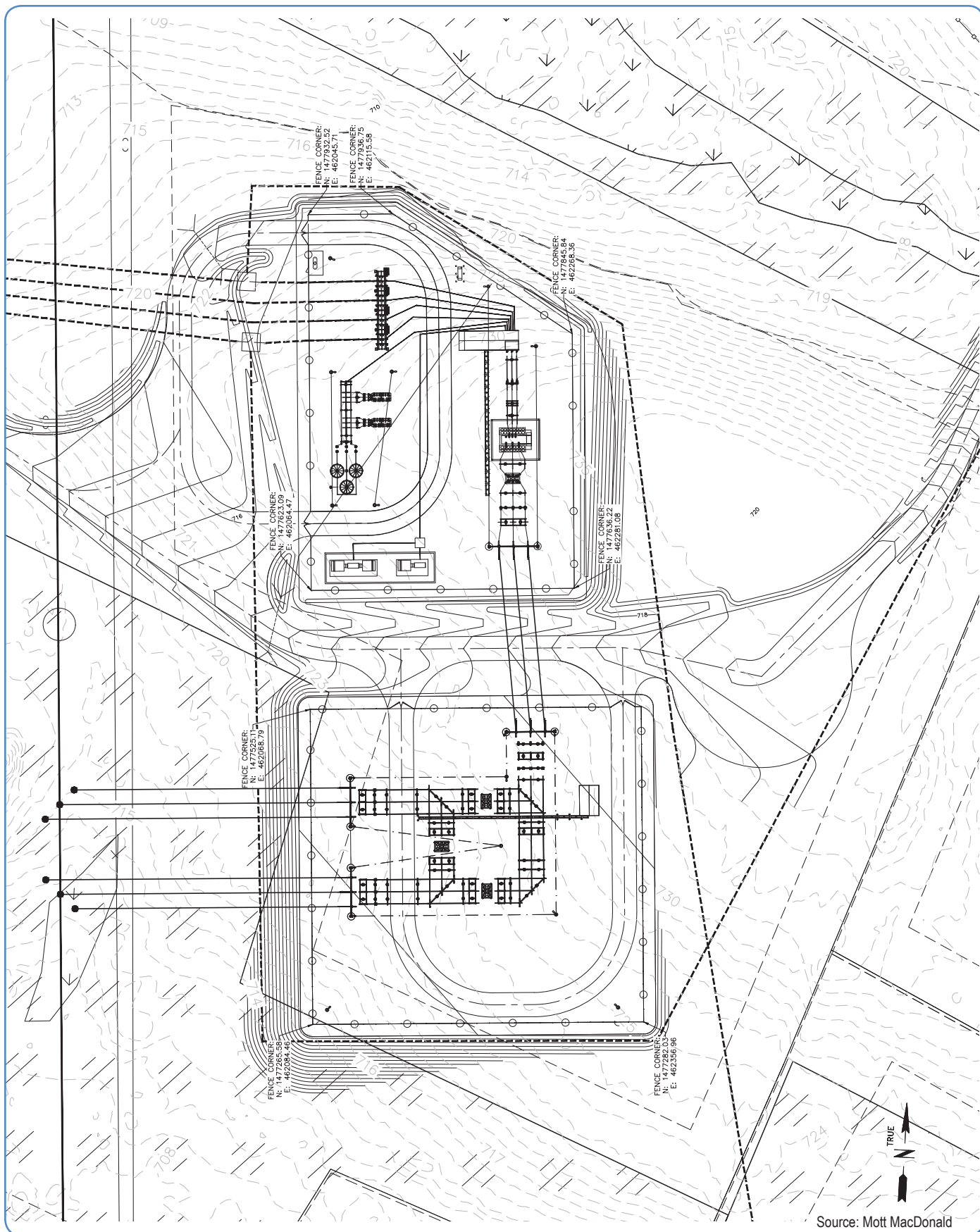

## Mohawk Solar

Towns of Canajoharie and Minden, Montgomery County, New York

Article 10 Application

**Figure 3-2: Interconnection Location**

Sheet 2 of 2: Substation and Switchyard Diagram

### LEGEND

	PROPOSED SITE ACCESS DRIVE
	EXISTING FORESTED AREA
	DELINEATED WETLAND/STREAM LOCATION
	PROPOSED UNDERGROUND ELECTRIC LINE
	PROPOSED PERIMETER FENCE

